

ER thread-cutting solutions

CYL SSY/HSK-A SSY Softsynchro® tapping holder

- // With **minimum length compensation**
- // Eliminates small synchronization errors of machines (Rigid Tapping)

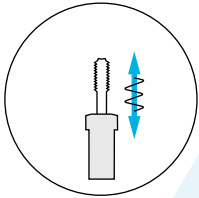

Applications

- // Machines for direct thread cutting
- // For all tapping tools with h9 shanks
- // The turning movement of the spindles can be offset with the feed axis and thus synchronized
- // Synchronization errors are created by the dynamics of the spindle and linear drives. The tapping holder is equipped with the minimum length compensation and compensates the synchronization errors
- // Guides coolant with up to 50 bar of pressure to the tap, without compromising length compensation
- // Depending on the application, the service life for the customer can be increased by up to 150%

Comparative axial force testing

Occurring axial forces with thread forms M10 in St37. Speed 500 rpm
Source: In-house testing

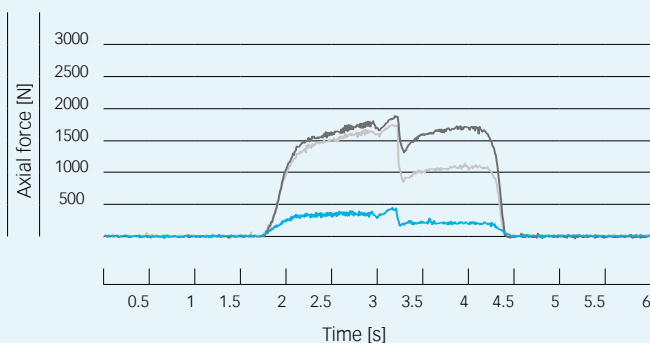

Summary The axial forces increase with increasing speed. With a rigid toolholder, the forces occurring when forming threads are considerably higher than with the Softsynchro® tapping holder. This allows for the optimum use of the synchronous spindle with the best possible service life and thread surface quality.

CYL GSF tapping holder

- // With **length compensation**
- // For machines without a tapping option

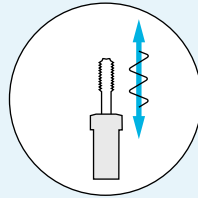

Applications

- // Used on machines in which the feed movement is not synchronized with the thread pitch during processing
- // Ensures the compensation of differences between the thread pitch and spindle feed
- // Features a pressure-point mechanism
- // Safe tap cutting
- // Uniform, reproducible thread depths
- // Guides coolant with up to 50 bar of pressure to the tap, without compromising length compensation
- // Universal use thanks to its compact design and low gauge length

Comparative axial force testing

Occurring axial forces with thread forms M10 in St37. Speed 2.000 rpm
Source: In-house testing

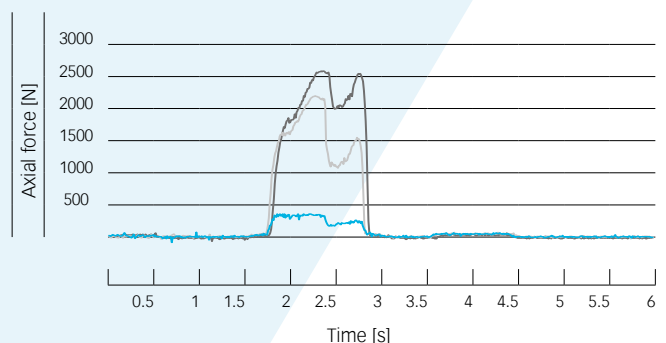

- REGO-FIX Softsynchro® tapping holders
- Competitor synchronous toolholder
- Rigid synchronous toolholder

ER tapping holders

HSK-A SSY

69893-A

ISO 12164

CYL SSY

DIN 1835 B+E

CYL GSF

DIN 1835 B+E

| Type | Part no. | Dimensions [mm] | | Compression | Tension | SW | Accessory |
|-----------------------|------------|-----------------|-------|-------------|---------|----|-----------|
| | | D | L | [mm] | [mm] | | Wrench |
| HSK-A 63 SSY | | | | | | | |
| HSK-A 63 SSY / ERC 20 | 2563.62000 | 34 | 95.5 | 0.5 | 0.5 | 19 | E 20 P |
| HSK-A 63 SSY / ERC 32 | 2563.63200 | 50 | 108.8 | 0.5 | 0.5 | 32 | E 32 |

Included in delivery: Tapping holder comes with Hi-Q® / ERC clamping nut

| Type | Part no. | Dimensions [mm] | | | | Compression | Tension | SW | Accessory |
|-------------------|------------|-----------------|----|------|----|-------------|---------|----|-----------|
| | | D | D1 | L | L1 | [mm] | [mm] | | Wrench |
| CYL 25 SSY | | | | | | | | | |
| CYL 25 SSY/ERC 20 | 2625.62000 | 34 | 25 | 73 | 57 | 0.5 | 0.5 | 19 | E 20 P |
| CYL 25 SSY/ERC 32 | 2625.63200 | 50 | 25 | 87.5 | 57 | 0.5 | 0.5 | 32 | E 32 |

Included in delivery: Tapping holder comes with Hi-Q® / ERC clamping nut

| Type | Part no. | Dimensions [mm] | | | | Compression | Tension | SW | Accessory |
|----------------------|------------|-----------------|----|-----|----|-------------|---------|----|-----------|
| | | D | D1 | L | L1 | [mm] | [mm] | | Wrench |
| CYL 25 GSF | | | | | | | | | |
| CYL 25 GSF / ERMC 20 | 2625.62001 | 28 | 25 | 85 | 57 | 5 | 7.5 | 28 | E 20 M |
| CYL 25 GSF / ERC 32 | 2625.63201 | 50 | 25 | 115 | 57 | 7 | 10 | 34 | E 32 |

Included in delivery: Tapping holder comes with Hi-Q® / ERC or Hi-Q® / ERMC clamping nut



HSK-A SSY / CYL SSY / CYL GSF

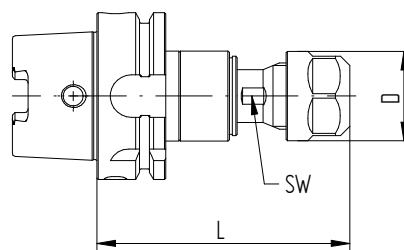

HSK-A 63 SSY / ERC

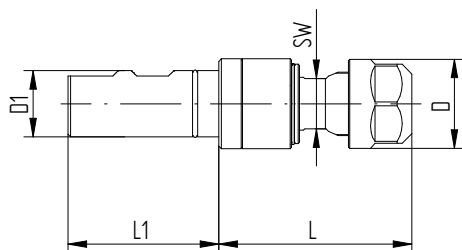

CYL 25 SSY / ERC

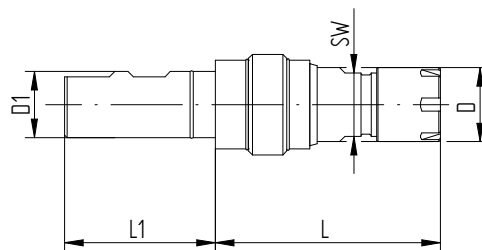

CYL 25 GSF